

## End Wire Connector

## End Wire Connector

### P6 End Wire Connector

- Material: Nylon 66, 94V-2with UL approval.
- Usage: Peel the coat of wire, then insert to tube, use pincers to fix them.
- Feature: Nylon shell, long copper tube, easy to conduct electricity and hold wire tightly.



Item.No.	A(mm)	W		D(mm)	Suitable Wires	
		B(mm)	C(mm)		mm <sup>2</sup>	AWG
P6-φ3	17.8	7.2	3.6	2.5	1.25	22-16
P6-φ4	21.0	8.2	4.0	2.9	2	16-14
P6-φ5	22.5	9.0	4.8	3.9	5.5	12-10
P6-φ6	25.0	10.0	5.6	4.5	8	8
P6-φ8	25.6	11.8	7.5	6.0	13	6
P6-φ10	29.5	13.5	9.3	7.5	16	4

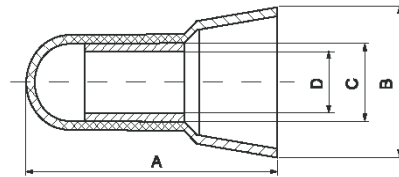

### P7 Self-screw Shell End Wire Connector

- Material: Nylon 66, with spring inside.
- Usage: Peel wire coat, insert the wire in, then tighten.



Item.No.	H(mm)	W(mm)	D(mm)	Suitable Wire(mm)
P7-1	15	8.7	6.5	MIN#20x1+#22x1,MAX#16x2
P7-2	18	10.0	7.5	MIN#20x3,MAX#16x3
P7-3	23	11.2	9.5	MIN#20x3,MAX#16x3+#18x1
P7-4	24.2	13.6	10.8	MIN#14x1+#18x1,MAX#14x4+#18x1
P7-5	27.8	16.1	12.7	MIN#14x2,MAX#10x2+#12x2

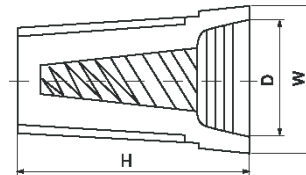

### P8 Self-screw Shell End Wire Connector

- Material: Nylon 66, with spring inside.
- Usage: peel wire coat, insert the wire in, then tighten.



Item.No.	H(mm)	W(mm)	D(mm)	Suitable Wire(mm)	Color
P8-1	22.0	19.0	9.8	MIN#18x2,MAX#12x3	Yellow
P8-2	29.0	22.0	12.5	MIN#14x2,MAX#10x4	Red

